

**Saint Louis University School of Medicine
Center for Anatomical Science and Education
Gift Body Program**

Saints Peter and Paul Cemetery Information

Saint Louis University School of Medicine Gift Body donor cremains are buried at Saints Peter and Paul Cemetery at 7030 Gravois Avenue, St. Louis, MO 63116. The map on page two provides directions to our grave (plot 39A). A marker was placed to express gratitude on behalf of students and faculty to those who chose to make this charitable donation.

The engraving at plot 39A reads as follows.

*"Saint Louis University and its students gratefully acknowledge the charity of those buried here, who gave their remains for the advancement of medical science."
September 29, 1964*



Cemetery plaque, plot 39A

The Catholic Cemeteries of the Archdiocese of St. Louis erected a Memorial Wall, the Sacred to the Memory of the Generous, at plot 27A where donor's names may be inscribed. For arrangements, write the Catholic Cemeteries of the Archdiocese at 6901 Mackenzie Road, St. Louis, MO 63123 or call 314-792-7737 or 314-792-7479.

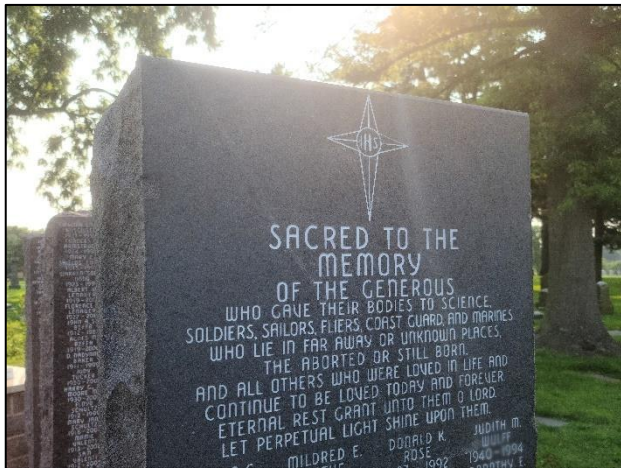

Sacred to the Memory of the Generous, plot 27A

The Memorial Wall inscription reads as follows.

"Sacred to the memory of the generous who gave their bodies to science, soldiers, sailors, fliers, Coast Guard, and Marines who lie in far away or unknown places, the aborted or still born, and all others who were loved in life and continue to be loved today and forever. Eternal rest grant unto them O Lord. Let perpetual light shine upon them."

A plaque has been placed on the Caroline Mall walkway by the School of Medicine honoring its donors that reads:

"The souls of the righteous are in the hand of God, and no torment will ever touch them. . .they are at peace." Wisdom of Solomon

"In memory and thanksgiving, the students, faculty, and the staff of Saint Louis University express appreciation to body donors and their families who made that precious gift in order that others might learn to heal." October, 1995



Caroline walkway plaque, SLU South Campus

The Archdiocese of St. Louis Saints Peter and Paul Cemetery

7030 Gravois Avenue, St. Louis, MO 63116

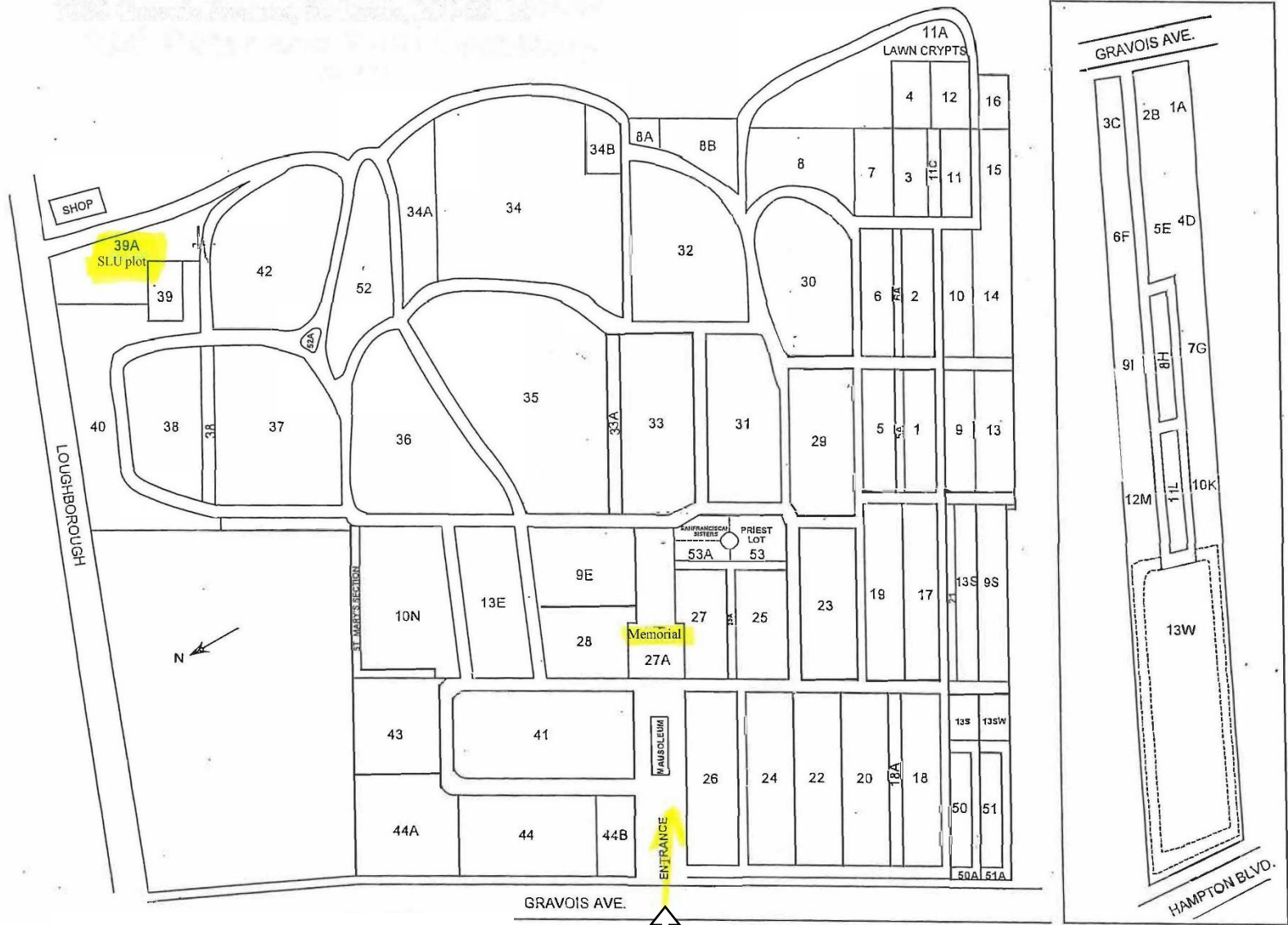

Entrance located at 7030 Gravois Ave.,
St. Louis, MO 63116

Sls. Peter and Paul.dsd



Catholic Cemeteries of the
Archdiocese of St. Louis

SACRED TO THE MEMORY LETTERING FORM

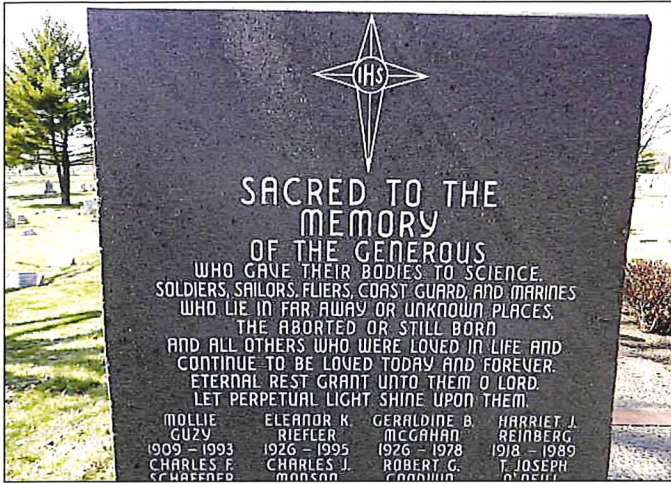

Saint Louis University donor cremains are buried in Section 39A of Sts. Peter and Paul Cemetery, 7030 Gravois, St. Louis, MO and they may be memorialized on the cemetery shrine in Section 27A near the entrance. Each inscription includes first name, middle initial, last name and years of birth and death, and consists of 3 lines (as shown above), with a maximum of 14 letters per line. Inscription work may be ordered prior to donation as well. In those cases where death has not yet occurred, upon future notification by a family member, the death year will be added at no charge.

When interested, please complete the form below and return with full payment of \$370.00 per individual to: Resurrection Cemetery, 6901 Mackenzie Road, St. Louis, MO 63123. Credit cards accepted. Checks payable to Catholic Cemeteries.

An invoice will be sent upon receipt of payment. You will be notified upon completion, in late spring or late autumn. Call 314.792.7737 or 314.792.7479 with any questions.

INSCRIPTION TO READ AS FOLLOWS (*please print clearly*):

First Name	Initial	Last Name	Year of Birth	Year of Death

I assume full responsibility for the accuracy of this order.

Signed: _____ Dated: _____

Purchaser Name: _____

Address: _____

City/State/Zip: _____

Phone: (_____) _____ E-mail: _____

Transaction: _____ Processed: _____ Notified: _____